

# DT SERIES FLOODED BATTERY

## DT126 (6V240Ah)

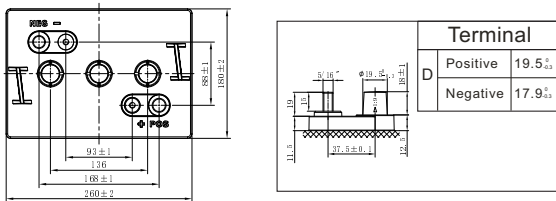
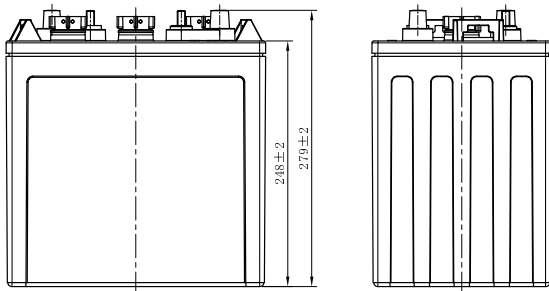

## CHARACTERISTICS

Item	Specifications	
Voltage	6V	
Dimension	Length	260mm (10.2inches)
	Width	180mm (7.09inches)
	Container Height	248mm (9.76inches)
	Total Height	279mm (11.0inches)
Approx Weight	29.7kg (65.5lbs)	
Terminal	DT(5/16")	
Container Material	PP	
Rated Capacity	20HR	240Ah
	5HR	195Ah
Reserve Capacity	25A	485min
	75A	130min

## GENERAL FEATURES

- Long cycle service life, strong recovery ability of deep discharge
- Low risk of thermal runaway, easy maintenance
- High energy, low internal resistance, low self-discharge
- Reliable sealing structure ensures no leakage during use
- Special design and structure increase battery performance
- The special alloy improves the corrosion resistance of the plate increases the service life and good deep discharge performance

## APPLICATIONS

- Electric vehicle
- Golf cart
- Sightseeing bus
- Cleaning equipment
- AWP
- Marine&RV

## Charging Characteristics

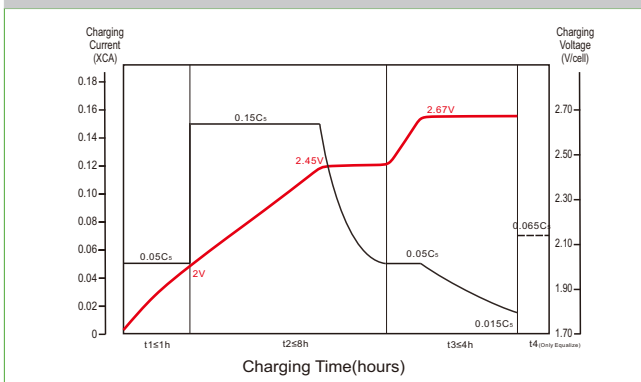

## Discharge Characteristics

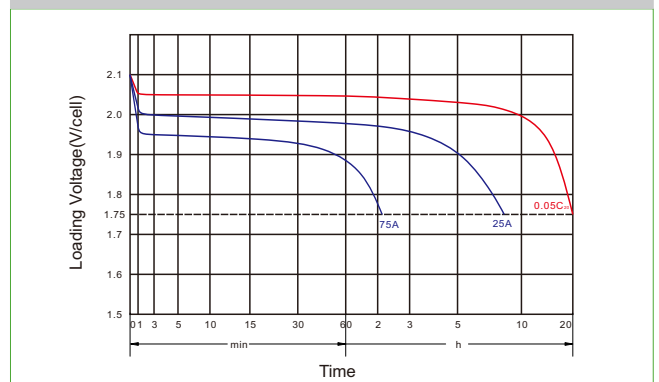

Designed in compliance with applicable BCI standard.  
Tested in compliance to BCI standard.

Leoch International Technology Ltd.

[www.leoch.com](http://www.leoch.com)

Leoch Batteries Pte Ltd

[www.leoch.sg](http://www.leoch.sg)

Leoch Battery Corporation

[www.leoch.us](http://www.leoch.us)

Leoch Europe S.A.

[www.leoch.eu](http://www.leoch.eu)